

BOLT HEAD PCB SUPPORTS

- Support with minimum chassis protrusion serves for limited space or slim line applications
- Head locks in boards, can be released by hand
- Screw locks support; steady and firm
- Material: Polyamide 6,6, UL94V-2
- Color: Natural

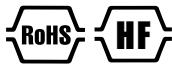
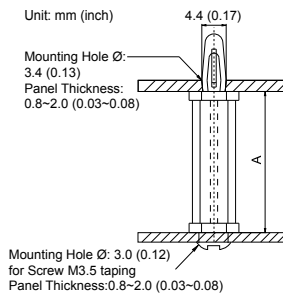

Part No.	Spacing Height (A) mm (inch)
CBS-6S	6.5±0.3 (0.26±0.01)
CBS-9S	9.6±0.3 (0.38±0.01)
CBS-13S	12.9±0.3 (0.51±0.01)
CBS-16S	16.0±0.3 (0.63±0.01)

Part No.	Spacing Height (A) mm (inch)
CBS-19S	19.3±0.3 (0.76±0.01)
CBS-22S	22.4±0.3 (0.88±0.01)
CBS-25S	25.5±0.3 (1.00±0.01)
CBS-29S	29.0±0.3 (1.14±0.01)

MINI CARD SPACER SUPPORTS

- Install by hand no tools required
- Insert the support through only one hole of board
- Thin button head for minimum protrusion can save more space
- Material: Polyamide 6,6, UL94V-2
- Color: Natural



Part No.	Spacing Height (A) mm (inch)
MCBS-4P	4.1±0.3 (0.16±0.01)
MCBS-6P	6.2±0.3 (0.24±0.01)
MCBS-8P	8.2±0.3 (0.32±0.01)
MCBS-10P	11.7±0.3 (0.46±0.01)
MCBS-14P	14.3±0.3 (0.56±0.01)

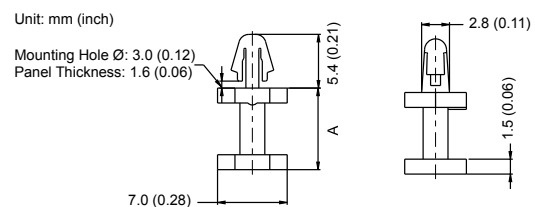

CIRCUIT BOARD BOLTS

- Easily installed by hand to lock securely
- Easily removed by pinching prong tips
- No tools is required
- Material: Polyamide 6,6, UL94V-2
- Color: Natural

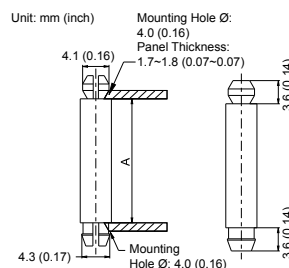

Part No.	Spacing Height (A) mm (inch)
HSP-2N	3.2±0.3 (0.13±0.01)
HSP-5N	4.8±0.3 (0.19±0.01)
HSP-6N	6.3±0.3 (0.25±0.01)
HSP-8N	7.9±0.3 (0.31±0.01)
HSP-9N	9.4±0.3 (0.37±0.01)

Part No.	Spacing Height (A) mm (inch)
HSP-11N	11.3±0.3 (0.45±0.01)
HSP-13N	12.7±0.3 (0.50±0.01)
HSP-16N	15.9±0.3 (0.63±0.01)
HSP-19N	19.1±0.3 (0.75±0.01)
HSP-22N	22.2±0.3 (0.87±0.01)