

NON-INSULATED SPADE TERMINALS

- Fork design provides fast and easy installation without removing the fastener
- Brazed seam protects terminal barrel from splitting during the crimping process
- Material: Copper

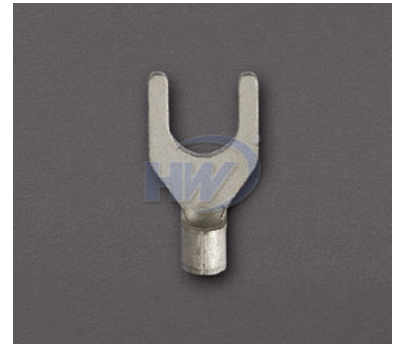
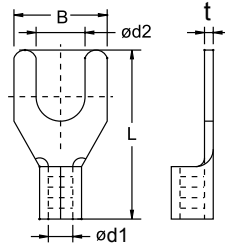

Part No.	Wire Range		Dimension mm (inch)					Stud Size	
	sq. mm.	AWG	d1	d2	B	L	t	mm	inch
Y1.25-3B	0.5-1.5	22-16	1.9 (0.07)	3.2 (0.13)	5.7 (0.22)	16.0 (0.63)	0.7 (0.03)	M3	#5
Y1.25-3.5SB	0.5-1.5	22-16	1.9 (0.07)	3.7 (0.15)	5.7 (0.22)	16.0 (0.63)	0.7 (0.03)	M3.5	#6
Y1.25-3.5B	0.5-1.5	22-16	1.9 (0.07)	3.7 (0.15)	6.2 (0.24)	16.0 (0.63)	0.7 (0.03)	M3.5	#6
Y1.25-4SB	0.5-1.5	22-16	1.9 (0.07)	4.3 (0.17)	6.4 (0.25)	16.0 (0.63)	0.7 (0.03)	M4	#8
Y1.25-4B	0.5-1.5	22-16	1.9 (0.07)	4.3 (0.17)	7.2 (0.28)	16.0 (0.63)	0.7 (0.03)	M4	#8
Y1.25-5B	0.5-1.5	22-16	1.9 (0.07)	5.3 (0.21)	8.0 (0.31)	16.0 (0.63)	0.7 (0.03)	M5	#10
Y1.25-6B	0.5-1.5	22-16	1.9 (0.07)	6.4 (0.25)	10.7 (0.42)	17.0 (0.67)	0.7 (0.03)	M6	1/4"
Y1.25-6SB	0.5-1.5	22-16	1.9 (0.07)	6.4 (0.25)	9.3 (0.37)	17.0 (0.67)	0.7 (0.03)	M6	1/4"
Y1.25-8B	0.5-1.5	22-16	1.9 (0.07)	8.4 (0.33)	13.5 (0.53)	22.1 (0.87)	0.7 (0.03)	M8	5/16"
Y2-3B	1.5-2.5	16-14	2.5 (0.10)	3.2 (0.13)	5.7 (0.22)	16.0 (0.63)	0.8 (0.03)	M3	#5
Y2-3.5SB	1.5-2.5	16-14	2.5 (0.10)	3.7 (0.15)	5.7 (0.22)	16.0 (0.63)	0.8 (0.03)	M3.5	#6
Y2-3.5B	1.5-2.5	16-14	2.5 (0.10)	3.7 (0.15)	6.2 (0.24)	16.0 (0.63)	0.8 (0.03)	M3.5	#6
Y2-4SB	1.5-2.5	16-14	2.5 (0.10)	4.3 (0.17)	6.4 (0.25)	16.0 (0.63)	0.8 (0.03)	M4	#8
Y2-4B	1.5-2.5	16-14	2.5 (0.10)	4.3 (0.17)	7.2 (0.28)	16.0 (0.63)	0.8 (0.03)	M4	#8
Y2-5B	1.5-2.5	16-14	2.5 (0.10)	5.3 (0.21)	8.0 (0.31)	16.0 (0.63)	0.8 (0.03)	M5	#10
Y2-6B	1.5-2.5	16-14	2.5 (0.10)	6.4 (0.25)	10.7 (0.42)	17.0 (0.67)	0.8 (0.03)	M6	1/4"
Y2-6SB	1.5-2.5	16-14	2.5 (0.10)	6.4 (0.25)	9.3 (0.37)	17.0 (0.67)	0.8 (0.03)	M6	1/4"
Y2-8B	1.5-2.5	16-14	2.5 (0.10)	8.4 (0.33)	13.5 (0.53)	22.1 (0.87)	0.8 (0.03)	M8	5/16"
Y3.5-3.5B	2.5-4.0	14-12	3.4 (0.13)	3.7 (0.15)	7.3 (0.29)	18.0 (0.71)	0.8 (0.03)	M3.5	#6
Y3.5-4B	2.5-4.0	14-12	3.4 (0.13)	4.3 (0.17)	8.0 (0.31)	18.0 (0.71)	0.8 (0.03)	M4	#8
Y3.5-5B	2.5-4.0	14-12	3.4 (0.13)	5.3 (0.21)	8.0 (0.31)	18.0 (0.71)	0.8 (0.03)	M5	#10
Y5.5-3B	4.0-6.0	12-10	3.6 (0.14)	3.2 (0.13)	7.3 (0.29)	19.5 (0.77)	1.0 (0.04)	M3	#5
Y5.5-3.5SB	4.0-6.0	12-10	3.6 (0.14)	3.7 (0.15)	6.3 (0.25)	19.5 (0.77)	1.0 (0.04)	M3.5	#6
Y5.5-3.5B	4.0-6.0	12-10	3.6 (0.14)	3.7 (0.15)	8.1 (0.32)	18.5 (0.73)	1.0 (0.04)	M3.5	#6
Y5.5-4B	4.0-6.0	12-10	3.6 (0.14)	4.3 (0.17)	8.2 (0.32)	19.5 (0.77)	1.0 (0.04)	M4	#8
Y5.5-4SB	4.0-6.0	12-10	3.6 (0.14)	4.3 (0.17)	6.3 (0.25)	19.5 (0.77)	1.0 (0.04)	M4	#8
Y5.5-5B	4.0-6.0	12-10	3.6 (0.14)	5.3 (0.21)	9.0 (0.35)	19.5 (0.77)	1.0 (0.04)	M5	#10
Y5.5-6B	4.0-6.0	12-10	3.6 (0.14)	6.4 (0.25)	12.0 (0.47)	23.1 (0.91)	1.0 (0.04)	M6	1/4"
Y5.5-6SB	4.0-6.0	12-10	3.6 (0.14)	6.4 (0.25)	9.0 (0.35)	23.0 (0.91)	1.0 (0.04)	M6	1/4"
Y5.5-8B	4.0-6.0	12-10	3.6 (0.14)	8.4 (0.33)	13.5 (0.53)	25.0 (0.98)	1.0 (0.04)	M8	5/16"