

## AUTOMATIC HARNESS CLIPS

- Bundle can be fastened in the clips without cable ties
- Wide and hard to release mount design provides secure protection and insulation for cables
- Applying by first drilling a hole on panel or board with appropriate hole diameter and board thickness, then inserting the mount head to the hole for fixture
- Push mount design with disc can enhance the stable of fixing
- **Special specifications supplied by customers' order**
- Material: Polyamide 6,6, UL94V-2
- Color: Black

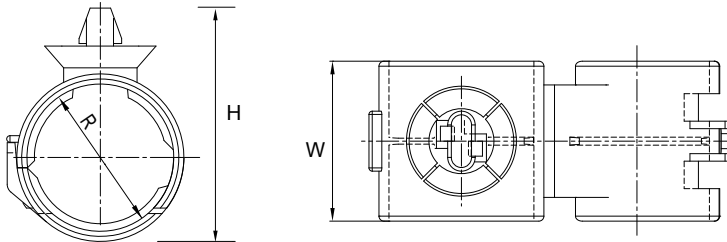

Part No.	Width (W) mm (inch)	Height (H) mm (inch)	Max.Bundle $\phi$ mm (inch)	Mounting Hole $\phi$ mm (inch)	Panel Thickness mm (inch)
FHC-001	32.0 (1.26)	46.0 (1.81)	29.0 (1.14)	$\phi$ 8.4 (0.33)	1.0~4.5 (0.04~0.18)
FHC-002	32.0 (1.26)	53.5 (2.11)	37.0 (1.46)	$\phi$ 8.6 (0.34)	1.0~4.8 (0.04~0.19)

## AUTOMATIC HARNESS HOSE CLIPS

- Fix the clip with screw on the board
- Circular clips are hard to release to secure the pipe or cables
- Reed design fits different size of pipes
- **Special specifications supplied by customers' order**
- Material: Polyamide 6,6, UL94V-2
- Color: Black

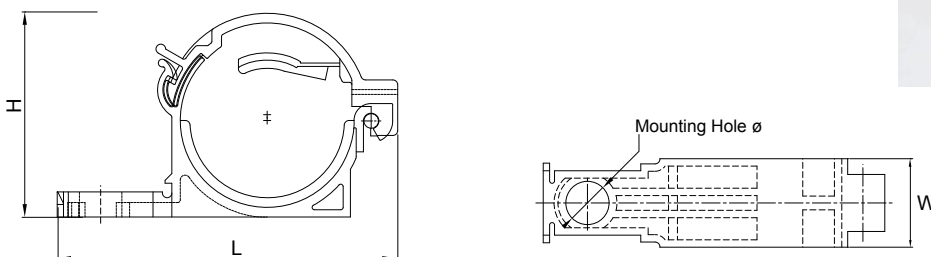

Part No.	Length (L) mm (inch)	Width (W) mm (inch)	Height (H) mm (inch)	Mounting Hole $\phi$ mm (inch)	Max. Bundle $\phi$ mm (inch)
FHC-003	70.6 (2.78)	18 (0.71)	42.2 (1.66)	$\phi$ 8.8 (0.35)	30 (1.18)