

C SERIES CLOSE-END CRIMP CONNECTORS

- Four models cover a wide range of wire combinations from 22 AWG strands through 10 AWG stranded
- Compact design fits easily into tight locations
- Flared skirt ensures easily wire entry and protects against turned-back strands
- UL Listed for 300V maximum building wiring; temperature rated at 105°C (221°F) maximum
- P/N with postfix V0 means the shell is UL94V-0 flame-retardant
- P/N with postfix "-L" means the tube is made of aluminum
- Material: UL approved 94V-2 Polyamide 6,6, copper tube or aluminum tube

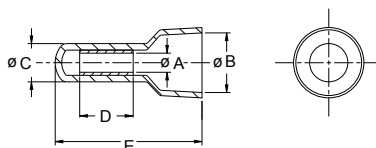

Part No.	Temp Rating	Voltage	Dimension mm (inch)					Suitable Wire AWG	Wire Strip Length mm (inch)	Color	Suitable Crimping Tools
			A	B	C	D	E				
C3	105°C (221°F)	300V	ø2.6 (0.10)	ø7.6 (0.30)	ø5.0 (0.20)	6.8 (0.27)	18.0 (0.71)	22-16	16.0 (0.63)	Natural	GIT-517C1
C4	105°C (221°F)	300V	ø3.2 (0.13)	ø7.6 (0.30)	ø5.8 (0.23)	6.8 (0.27)	20.4 (0.80)	22-14	16.0 (0.63)	Natural	
C5	105°C (221°F)	300V	ø4.3 (0.17)	ø10.3 (0.41)	ø7.0 (0.28)	7.8 (0.31)	24.8 (0.98)	22-10	20.0 (0.79)	Natural	
C8	105°C (221°F)	300V	ø5.0 (0.20)	ø12.2 (0.48)	ø9.2 (0.36)	8.8 (0.35)	27.0 (1.06)	20-10	21.0 (0.83)	Natural	GIT-517C5
C3-L	105°C (221°F)	300V	ø2.6 (0.10)	ø7.6 (0.30)	ø5.0 (0.20)	6.8 (0.27)	18.0 (0.71)	22-16	16.0 (0.63)	Natural	GIT-517C1
C4-L	105°C (221°F)	300V	ø3.2 (0.13)	ø7.6 (0.30)	ø5.8 (0.23)	6.8 (0.27)	20.4 (0.80)	22-14	16.0 (0.63)	Natural	
C5-L	105°C (221°F)	300V	ø4.3 (0.17)	ø10.3 (0.41)	ø7.0 (0.28)	7.8 (0.31)	24.8 (0.98)	22-10	20.0 (0.79)	Natural	
C3V0	105°C (221°F)	300V	ø2.6 (0.10)	ø7.6 (0.30)	ø5.0 (0.20)	6.8 (0.27)	18.0 (0.71)	22-16	16.0 (0.63)	White	GIT-517C1
C4V0	105°C (221°F)	300V	ø3.2 (0.13)	ø7.6 (0.30)	ø5.8 (0.23)	6.8 (0.27)	20.4 (0.80)	22-14	16.0 (0.63)	White	
C5V0	105°C (221°F)	300V	ø4.3 (0.17)	ø10.3 (0.41)	ø7.0 (0.28)	7.8 (0.31)	24.8 (0.98)	22-10	20.0 (0.79)	White	
C3-LV0	105°C (221°F)	300V	ø2.6 (0.10)	ø7.6 (0.30)	ø5.0 (0.20)	6.8 (0.27)	18.0 (0.71)	22-16	16.0 (0.63)	White	GIT-517C1
C4-LV0	105°C (221°F)	300V	ø3.2 (0.13)	ø7.6 (0.30)	ø5.8 (0.23)	6.8 (0.27)	20.4 (0.80)	22-14	16.0 (0.63)	White	
C5-LV0	105°C (221°F)	300V	ø4.3 (0.17)	ø10.3 (0.41)	ø7.0 (0.28)	7.8 (0.31)	24.8 (0.98)	22-10	20.0 (0.79)	White	

Wire Termination
Wire Connectors