

UN-INSULATED CORD-END TERMINALS

- Designed with a seamless barrel to contain loose wire strands for superior terminations
- Ease of inserting wire into terminal block
- Meets DIN standards for wire containment
- Suitable for limited space panel applications
- Multiple pin lengths available for a variety of terminal blocks
- Material: Copper tube with tin plated

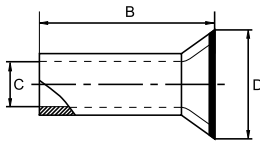

Part No.	Conductor		Dimension mm (inch)			Tools
	sq. mm.	AWG	B	C	D	
CN005006	0.50	22-20	6.0 (0.24)	1.0 (0.04)	2.1 (0.08)	GIT-510 GIT-516E1
CN005008	0.50	22-20	8.0 (0.31)	1.0 (0.04)	2.1 (0.08)	
CN005010	0.50	22-20	10.0 (0.39)	1.0 (0.04)	2.1 (0.08)	
CN007506	0.75	20-19	6.0 (0.24)	1.2 (0.05)	2.3 (0.09)	
CN007508	0.75	20-19	8.0 (0.31)	1.2 (0.05)	2.3 (0.09)	
CN007510	0.75	20-19	10.0 (0.39)	1.2 (0.05)	2.3 (0.09)	
CN010006	1.00	18	6.0 (0.24)	1.4 (0.06)	2.5 (0.10)	
CN010008	1.00	18	8.0 (0.31)	1.4 (0.06)	2.5 (0.10)	
CN010010	1.00	18	10.0 (0.39)	1.4 (0.06)	2.5 (0.10)	
CN010012	1.00	18	12.0 (0.47)	1.4 (0.06)	2.5 (0.10)	
CN015007	1.50	16	7.0 (0.28)	1.7 (0.07)	2.8 (0.11)	
CN015008	1.50	16	8.0 (0.31)	1.7 (0.07)	2.8 (0.11)	
CN015010	1.50	16	10.0 (0.39)	1.7 (0.07)	2.8 (0.11)	
CN015012	1.50	16	12.0 (0.47)	1.7 (0.07)	2.8 (0.11)	
CN025007	2.50	14	7.0 (0.28)	2.2 (0.09)	3.4 (0.13)	
CN025008	2.50	14	8.0 (0.31)	2.2 (0.09)	3.4 (0.13)	
CN025010	2.50	14	10.0 (0.39)	2.2 (0.09)	3.4 (0.13)	
CN025012	2.50	14	12.0 (0.47)	2.2 (0.09)	3.4 (0.13)	
CN025018	2.50	14	18.0 (0.71)	2.2 (0.09)	3.4 (0.13)	
CN040008	4.00	12	8.0 (0.31)	2.8 (0.11)	4.0 (0.16)	
CN040009	4.00	12	9.0 (0.35)	2.8 (0.11)	4.0 (0.16)	
CN040010	4.00	12	10.0 (0.39)	2.8 (0.11)	4.0 (0.16)	

Wire Termination
Cord-End Terminals

UN-INSULATED CORD-END TERMINALS

Part No.	Conductor		Dimension mm (inch)			Tools
	sq. mm.	AWG	B	C	D	
CN040012	4.00	12	12.0 (0.47)	2.8 (0.11)	4.0 (0.16)	GIT-516E1
CN040015	4.00	12	15.0 (0.59)	2.8 (0.11)	4.0 (0.16)	
CN040018	4.00	12	18.0 (0.71)	2.8 (0.11)	4.0 (0.16)	
CN060010	6.00	10	10.0 (0.39)	3.5 (0.14)	4.7 (0.19)	GIT-516E2
CN060012	6.00	10	12.0 (0.47)	3.5 (0.14)	4.7 (0.19)	
CN060015	6.00	10	15.0 (0.59)	3.5 (0.14)	4.7 (0.19)	
CN060018	6.00	10	18.0 (0.71)	3.5 (0.14)	4.7 (0.19)	
CN100012	10.00	8	12.0 (0.47)	4.5 (0.18)	5.8 (0.23)	GIT-516E2 GIT-516E3 GIT-518
CN100015	10.00	8	15.0 (0.59)	4.5 (0.18)	5.8 (0.23)	
CN100018	10.00	8	18.0 (0.71)	4.5 (0.18)	5.8 (0.23)	
CN160012	16.00	6	12.0 (0.47)	5.8 (0.23)	7.5 (0.30)	
CN160015	16.00	6	15.0 (0.59)	5.8 (0.23)	7.5 (0.30)	
CN160018	16.00	6	18.0 (0.71)	5.8 (0.23)	7.5 (0.30)	
CN250015	25.00	4	15.0 (0.59)	7.3 (0.29)	9.5 (0.37)	GIT-516E3 GIT-516E4 GIT-518
CN250016	25.00	4	16.0 (0.63)	7.3 (0.29)	9.5 (0.37)	
CN250018	25.00	4	18.0 (0.71)	7.3 (0.29)	9.5 (0.37)	
CN250020	25.00	4	20.0 (0.79)	7.3 (0.29)	9.5 (0.37)	
CN250022	25.00	4	22.0 (0.87)	7.3 (0.29)	9.5 (0.37)	
CN350016	35.00	2	16.0 (0.63)	8.3 (0.33)	11.0 (0.43)	GIT-516E4 GIT-518
CN350018	35.00	2	18.0 (0.71)	8.3 (0.33)	11.0 (0.43)	
CN350020	35.00	2	20.0 (0.79)	8.3 (0.33)	11.0 (0.43)	
CN350025	35.00	2	25.0 (0.98)	8.3 (0.33)	11.0 (0.43)	
CN500018	50.00	1/0	18.0 (0.71)	10.3 (0.41)	13.0 (0.51)	
CN500020	50.00	1/0	20.0 (0.79)	10.3 (0.41)	13.0 (0.51)	
CN500022	50.00	1/0	22.0 (0.87)	10.3 (0.41)	13.0 (0.51)	
CN500025	50.00	1/0	25.0 (0.98)	10.3 (0.41)	13.0 (0.51)	
CN700022	70.00	2/0	22.0 (0.87)	13.5 (0.53)	15.3 (0.60)	GIT-518
CN700025	70.00	2/0	25.0 (0.98)	13.5 (0.53)	15.3 (0.60)	
CN700032	70.00	2/0	32.0 (1.26)	13.5 (0.53)	15.3 (0.60)	
CN950025	95.00	3/0	25.0 (0.98)	14.7 (0.58)	16.6 (0.65)	
CN950032	95.00	3/0	32.0 (1.26)	14.7 (0.58)	16.6 (0.65)	
CN120030	120.00	4/0	30.0 (1.18)	16.7 (0.66)	18.6 (0.73)	
CN120032	120.00	4/0	32.0 (1.26)	16.7 (0.66)	18.6 (0.73)	
CN120034	120.00	4/0	34.0 (1.34)	16.7 (0.66)	18.6 (0.73)	
CN150032	150.00	250/300	32.0 (1.26)	19.5 (0.77)	21.5 (0.85)	
CN150038	150.00	250/300	38.0 (1.50)	19.5 (0.77)	21.5 (0.85)	

* DIN 46228/1