

# VINYL-INSULATED SPADE TERMINALS

- Fork design provides fast and easy installation without removing the fastener
- Insulation support helps to prevent wire damage in bending applications
- Material: Copper tube with tin plated end sleeves with insulation PVC

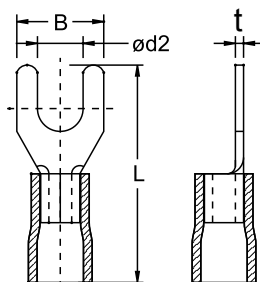

Part No.	Color	Wire Range		Dimension mm (inch)				Stud Size	
		sq. mm.	AWG	B	d2	L	t	mm	inch
VY1.25-3	Red	0.5-1.5	22-16	5.7 (0.22)	3.2 (0.13)	22.0 (0.87)	0.8 (0.03)	M3	#5
VY1.25-3.5	Red	0.5-1.5	22-16	6.2 (0.24)	3.7 (0.15)	22.0 (0.87)	0.8 (0.03)	M3.5	#6
VY1.25-3.5S	Red	0.5-1.5	22-16	5.7 (0.22)	3.7 (0.15)	22.0 (0.87)	0.8 (0.03)	M3.5	#6
VY1.25-4	Red	0.5-1.5	22-16	7.2 (0.28)	4.3 (0.17)	22.0 (0.87)	0.8 (0.03)	M4	#8
VY1.25-4S	Red	0.5-1.5	22-16	6.4 (0.25)	4.3 (0.17)	22.0 (0.87)	0.8 (0.03)	M4	#8
VY1.25-5	Red	0.5-1.5	22-16	8.0 (0.31)	5.3 (0.21)	22.0 (0.87)	0.8 (0.03)	M5	#10
VY1.25-6	Red	0.5-1.5	22-16	10.7 (0.42)	6.4 (0.25)	23.0 (0.91)	0.8 (0.03)	M6	1/4"
VY1.25-6S	Red	0.5-1.5	22-16	9.3 (0.37)	6.4 (0.25)	23.0 (0.91)	0.8 (0.03)	M6	1/4"
VY1.25-8	Red	0.5-1.5	22-16	13.5 (0.53)	8.4 (0.33)	28.0 (1.10)	0.8 (0.03)	M8	5/16"
VY2-3	Blue	1.5-2.5	16-14	5.7 (0.22)	3.2 (0.13)	22.5 (0.89)	0.8 (0.03)	M3	#5
VY2-3.5	Blue	1.5-2.5	16-14	6.2 (0.24)	3.7 (0.15)	22.5 (0.89)	0.8 (0.03)	M3.5	#6
VY2-3.5S	Blue	1.5-2.5	16-14	5.7 (0.22)	3.7 (0.15)	22.5 (0.89)	0.8 (0.03)	M3.5	#6
VY2-4	Blue	1.5-2.5	16-14	7.2 (0.28)	4.3 (0.17)	22.5 (0.89)	0.8 (0.03)	M4	#8
VY2-4S	Blue	1.5-2.5	16-14	6.4 (0.25)	4.3 (0.17)	22.5 (0.89)	0.8 (0.03)	M4	#8
VY2-5	Blue	1.5-2.5	16-14	8.0 (0.31)	5.3 (0.21)	22.5 (0.89)	0.8 (0.03)	M5	#10
VY2-6	Blue	1.5-2.5	16-14	10.7 (0.42)	6.4 (0.25)	23.5 (0.93)	0.8 (0.03)	M6	1/4"
VY2-6S	Blue	1.5-2.5	16-14	9.3 (0.37)	6.4 (0.25)	23.5 (0.93)	0.8 (0.03)	M6	1/4"
VY2-8	Blue	1.5-2.5	16-14	13.5 (0.53)	8.4 (0.33)	28.5 (1.12)	0.8 (0.03)	M8	5/16"
VY5.5-3	Yellow	4.0-6.0	12-10	7.3 (0.29)	3.2 (0.13)	26.7 (1.05)	1.0 (0.04)	M3	#5
VY5.5-3.5	Yellow	4.0-6.0	12-10	8.1 (0.32)	3.7 (0.15)	26.7 (1.05)	1.0 (0.04)	M3.5	#6
VY5.5-3.5S	Yellow	4.0-6.0	12-10	6.3 (0.25)	3.7 (0.15)	26.7 (1.05)	1.0 (0.04)	M3.5	#6
VY5.5-4	Yellow	4.0-6.0	12-10	8.2 (0.32)	4.3 (0.17)	26.7 (1.05)	1.0 (0.04)	M4	#8
VY5.5-4S	Yellow	4.0-6.0	12-10	6.3 (0.25)	4.3 (0.17)	26.7 (1.05)	1.0 (0.04)	M4	#8
VY5.5-5	Yellow	4.0-6.0	12-10	9.0 (0.35)	5.3 (0.21)	26.7 (1.05)	1.0 (0.04)	M5	#10
VY5.5-6	Yellow	4.0-6.0	12-10	12.0 (0.47)	6.4 (0.25)	30.7 (1.21)	1.0 (0.04)	M6	1/4"
VY5.5-6S	Yellow	4.0-6.0	12-10	9.0 (0.35)	6.4 (0.25)	30.7 (1.21)	1.0 (0.04)	M6	1/4"
VY5.5-8	Yellow	4.0-6.0	12-10	13.5 (0.53)	8.4 (0.33)	32.6 (1.28)	1.0 (0.04)	M8	5/16"

Wire Termination  
Terminals