

NON-INSULATED PIN TERMINALS

- Solid pin designed to prevent damage to the wire from over tightening, resulting in a reliable electrical connection
- Brazed seam protects terminal barrel from splitting during the crimping process
- Material: Copper

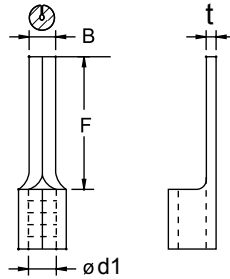

| Part No. | Wire Range | | Dimension mm (inch) | | | |
|------------|------------|-------|---------------------|------------|-------------|------------|
| | sq. mm. | AWG | d1 | B | F | t |
| P1.25-9B | 0.5-1.5 | 22-16 | 1.9 (0.07) | 2.0 (0.08) | 9.0 (0.35) | 0.8 (0.03) |
| P1.25-12B | 0.5-1.5 | 22-16 | 1.9 (0.07) | 2.0 (0.08) | 12.0 (0.47) | 0.8 (0.03) |
| P2-9B | 1.5-2.5 | 16~14 | 2.5 (0.10) | 2.0 (0.08) | 9.0 (0.35) | 0.8 (0.03) |
| P2-12B | 1.5-2.5 | 16~14 | 2.5 (0.10) | 2.0 (0.08) | 12.0 (0.47) | 0.8 (0.03) |
| P5.5-13.5B | 4.0-6.0 | 12~10 | 3.7 (0.15) | 2.7 (0.11) | 13.5 (0.53) | 1.0 (0.04) |

VINYL-INSULATED PIN TERMINALS

- Solid pin designed to prevent damage to the wire from over tightening, resulting in a reliable electrical connection
- Insulation support helps to prevent wire damage in bending applications
- Material: Copper tube with tin plated end sleeves with insulation PVC

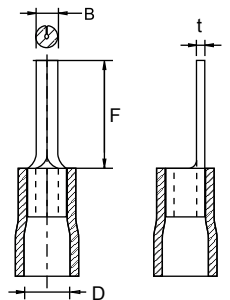

| Part No. | Color | Wire Range | | Dimension mm (inch) | | | |
|------------|--------|------------|-------|---------------------|------------|-------------|------------|
| | | sq. mm. | AWG | D | B | F | t |
| VP1.25-9 | Red | 0.5-1.5 | 22-16 | 4.3 (0.17) | 2.0 (0.08) | 9.0 (0.35) | 0.8 (0.03) |
| VP1.25-12 | Red | 0.5-1.5 | 22-16 | 4.3 (0.17) | 2.0 (0.08) | 12.0 (0.47) | 0.8 (0.03) |
| VP2-9 | Blue | 1.5-2.5 | 16-14 | 4.7 (0.19) | 2.0 (0.08) | 9.0 (0.35) | 0.8 (0.03) |
| VP2-12 | Blue | 1.5-2.5 | 16-14 | 4.7 (0.19) | 2.0 (0.08) | 12.0 (0.47) | 0.8 (0.03) |
| VP5.5-13.5 | Yellow | 4.0-6.0 | 12-10 | 6.7 (0.26) | 2.7 (0.11) | 13.5 (0.53) | 1.0 (0.04) |